

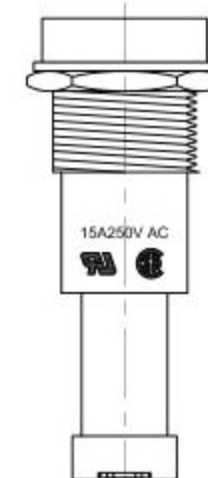

## Recommend hole sizes

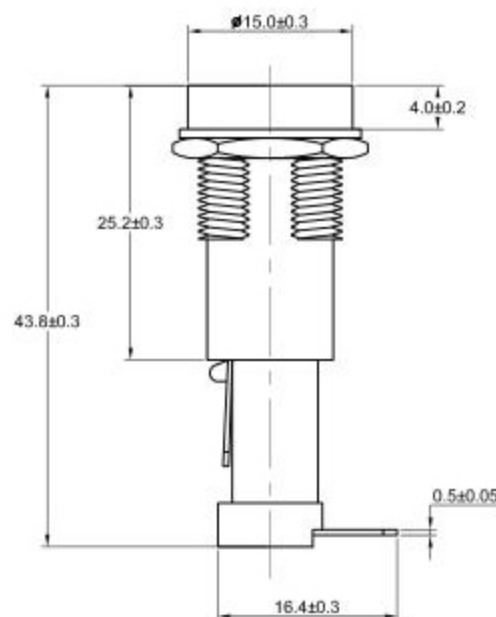
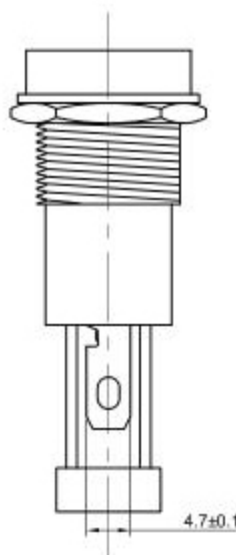
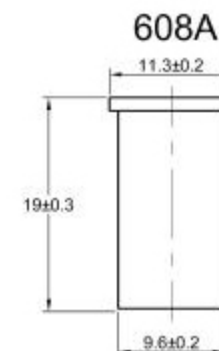
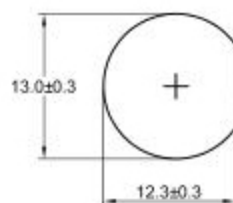

FUSE HOLDER PANEL MOUNT TYPE FOR 6.3X30mm  
AND 6.3X32mm FUSE USE

APPROVED 

SPECIFICATIONS:

\*Electrical: Rated at 15A 250V AC

\*Insulating Body: Thermoplastic

\*Kont: Screw-driver slot extractor type with nickel-plated  
copper alloy insert. Spring loaded.

\*Terminals: Nickel-plated copper alloy, solder type.

UNLESS OTHERWISE SPECIFIED  
DIMENSIONS ARE IN MM  
TOLERANCE  
DECIMALS ANGULAR  
X ± 0.5 ± 2°  
XX ± 0.25  
DO NOT SCALE DRAWING

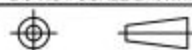

MATERIAL

REV

1.2

CUSTOMER NO.

DRAWN BY LING

CHECKED BY

APPROVED BY

DATE 2005.09.26

SCALE

深圳市健祥电子有限公司

TITLE

Panel Mount Fuse Holder

PART NO.

Z-608A

DRAWING NO.

AA05022404